

CURA GOOSE NECK KITCHEN MIXER - CHROME  
44430.02

ELEMENTi

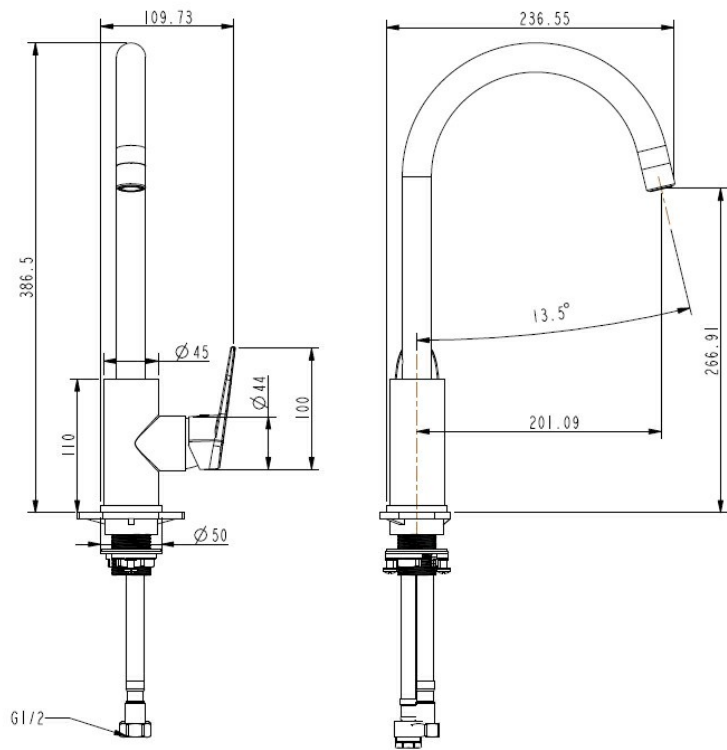

Residential/Light  
Commercial Use

Suitable for Residential/Light Commercial Use (Kitchens,  
Bathrooms and Laundries in Hotels, Motels and  
Retirement Villages).



Guarantee

10 Year Guarantee



5 Star WELS rating

6 litres per minute



Mains Pressure

Suitable for Mains  
Pressure.



Lead Free

Lead Free brass which contains 0.25% or less lead  
content. Complies with international "Lead Free"  
standards



Flawless Finish

Advanced plating provides a durable surface with a long  
lasting finish



Effortless Control

Advanced cartridge technology provides a wide operating  
angle and smooth operation



5 Ticks Standards  
Mark

<p>The 5 Ticks Standards Mark™ certifies this product  
meet strict quality, safety, and performance standards.  
</p>



BPIR - Importer

Robertson NZ Ltd.



BPIR - Place of  
Manufacture

Manufactured in China.





**BPIR - Relevance Documentation**

For detailed information on Relevant Building Codes & Statement of Contribution please visit [ROBERTSON.CO.NZ/DOWNLOADS](https://robertson.co.nz/downloads) and browse the relevant section



**BPIR - Scope of use**

Kitchen mixers are used in residential kitchens to control water flow and temperature for sinks, facilitating everyday cooking and cleaning tasks.



**BPIR - B2.3.1 Durability**

This product complies with Building Code Regulation B2.3.1 Durability



**BPIR - G12.3.2 (B) G12 Water Supplies**

This product complies with Building Code Regulation G12.3.2 (B) G12 Water Supplies



**BPIR - G12.3.7 G12 Water Supplies**

This product complies with Building Code Regulation G12.3.7 G12 Water Supplies

Combining state of the art manufacturing and cutting edge design that's fit for you and the family.