

PRODUCT SPECIFICATIONS

PACIFIC RISE 400 WALL HAND BASIN



PRODUCT CODES & FINISHES

COMPLETE YOUR CHOSEN PRODUCT CODE BELOW BY SPECIFYING HINGE POSITION AT THE END OF CODE

USE **L** FOR LEFT HAND HINGE; **R** FOR RIGHT HAND HINGE



4PAC040WD01NH
White Melamine



4PAC040WD23NH
Baroque



4PAC040WD93NH
Charred Oak

CABINET

INSTALLATION	Wall hung
CONFIGURATION	1 soft-close door
MATERIAL	Moisture resistant board
WIDTH (mm)	390
DEPTH (mm)	214
HEIGHT (mm)	400
ORIGIN	Aotearoa / New Zealand

VANITY TOP

FINISH	Gloss White
MATERIAL	Vitreous China
TAP HOLE	Yes
OVERFLOW	Yes
WASTE SIZE	Suits 32mm and 40mm waste traps
WASTE INCLUDED	No
WIDTH (mm)	400
DEPTH (mm)	220
ORIGIN	PRC

NOTES

- 5 year warranty *
- Cabinets made from moisture resistant board with PUR bonding technology are sustainably sourced from FSC certified NZ Radiata Pine.
- Optional - Pop-up Waste.**

SEPTEMBER 2024

ALL MEASUREMENTS ARE NOMINAL.

*WARRANTIES APPLY TO RESIDENTIAL DOMESTIC USE ONLY. WARRANTY IS VOID IF PRODUCT IS NOT INSTALLED ACCORDING TO OUR SPECIFICATIONS.

**REFER TO WEBSITE FOR FURTHER INFORMATION ON INSTALLATION GUIDE AND PRODUCT OPTIONS.

TECHNICAL SPECIFICATIONS

PACIFIC RISE 400 WALL HAND BASIN

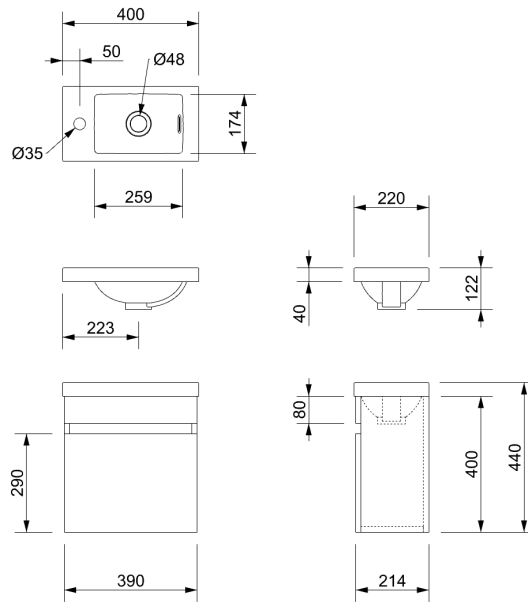

SEPTEMBER 2024

ALL MEASUREMENTS ARE NOMINAL.

*WARRANTIES APPLY TO RESIDENTIAL DOMESTIC USE ONLY. WARRANTY IS VOID IF PRODUCT IS NOT INSTALLED ACCORDING TO OUR SPECIFICATIONS.

**REFER TO WEBSITE FOR FURTHER INFORMATION ON INSTALLATION GUIDE AND PRODUCT OPTIONS.