

For further information or specifications, visit the technical section of our website [www.escea.com](http://www.escea.com) to view the latest product Installation Manual.

## Appliance Information

### Specifications

Heat Output	8 kW*
Star Rating	5 stars
Gas Input / Consumption	36 MJ/hr
Gas Connection	Lower centre of appliance, 1/2" BSP
Gas Type	Natural Gas / ULPG / Propane (Aus)
Power Requirement	3 pin earthed 230V power outlet to be within 1.0m of right side of the appliance.
Appliance Weight	120kg

\*subject to change pending lab results

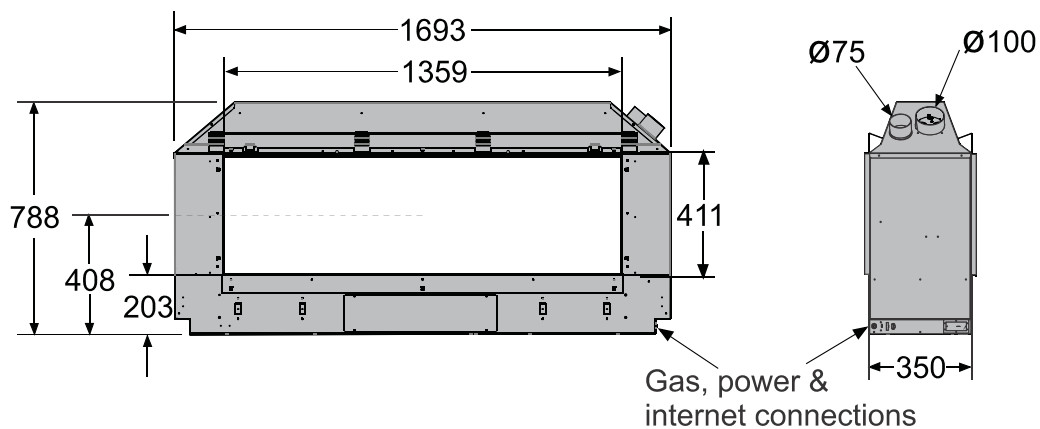

DS1400 Chassis Dimensions (mm)

## Cavity Construction

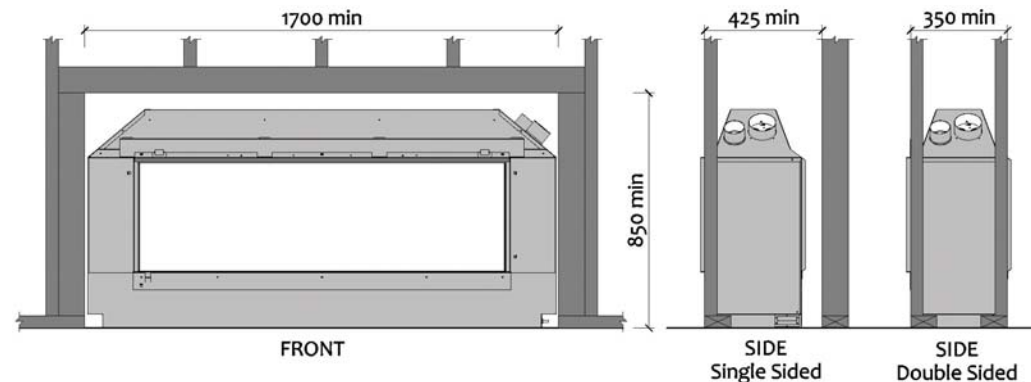

### Minimum Cavity Dimensions (mm):

The appliance must be installed prior to and behind the finished wall surface. Take into account any plaster board, tiles or any other finishing surface that may be intended for the finished wall surface.

Wall finishing materials must not encroach upon the minimum cavity clearances shown.

The wall board that lines the outside of the opening can be normal plaster board and does not need to be non-combustible.

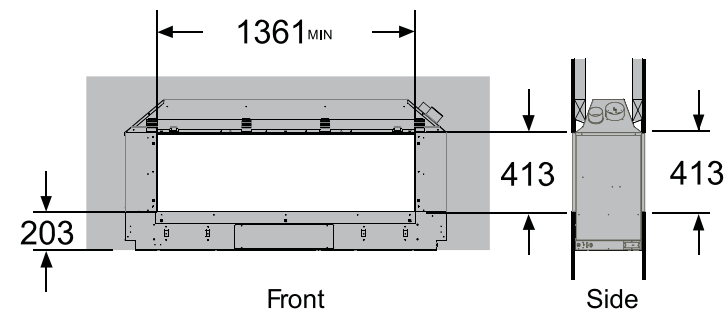

Wall opening size for frameless / no fascia (mm)

## Flue Information

### Flue Configuration (under 4m of flue length)

If your flue system is less than 4m long (as shown in diagrams below), then a simple aluminium flexible flue is required. If you wish to install a longer flue run, up to 12m, see section B3.

The horizontal offset of the terminal can be any amount up to the total flue length listed below. Please consult with Escea's technical staff if your intended flue configuration steps outside of the bounds of the flue configurations shown below.

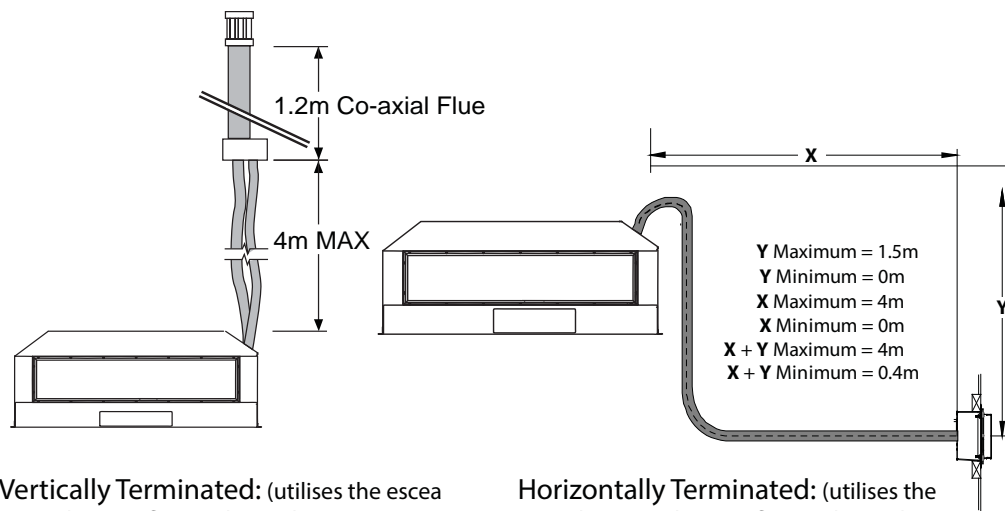

**Vertically Terminated:** (utilises the escea vertical power flue enclosure kit)

**Horizontally Terminated:** (utilises the escea horizontal power flue enclosure kit)

### External Vertical Powerflue cowl unit

The EVP is designed to have the box containing the fan and electricals mounted externally for installations. The EVP installation must be weather proof and conform to all local council standards including powered flue roof termination rules.

The cowl surround should be fixed in place as shown.

Depending on the kit purchased, mount the EVP kit to the top of a chimney flashing plate or penetrate the roof with an optional flue liner accessory and fit the EVP kit over the flue liner; sealing the penetration with a decktite or similar flashing. Ensure the terminal is vertical and rigidly mounted and the flexi flue attached below is fixed to the terminal spigots using the supplied hose clamps and is held in place by drilling 3 holes and screwing 3 self tapping screws evenly around each hose band clamp (as shown in the picture below).

Note: When installing the unit onto a flue liner, ensure the length of flue liner above the roof is the minimum required length.

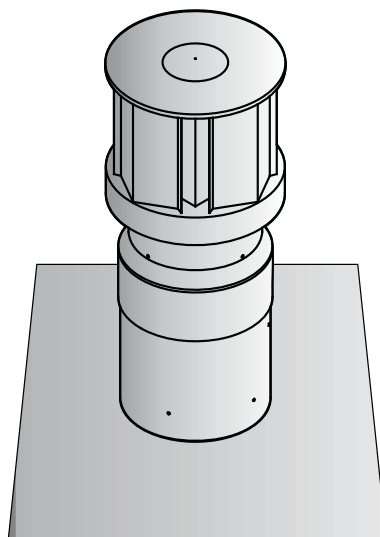

## Clearances

### Chassis Clearance

There must be a 50mm standoff (shown with hatching) applied all combustible materials on the top of the firebox chassis and the first 600mm of the flue (past this 600mm point, the flue is zero clearance).

If the installation is to be single sided, this standoff also applies to the back of the firebox chassis.

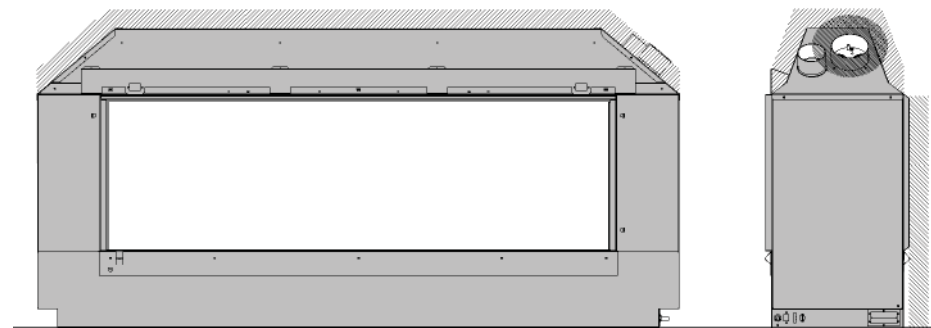

### Television Clearances

The following are the recommended minimum clearances for the location of any electrical equipment (such as Plasma TV, LCD TV or home theatre) above an Escea AF-Series gas fire. Use either a shelf or mantle below your TV screen or alternatively you can construct a recess to mount your TV screen into.

Note: The television clearance recommendations below are to be treated as a suggestion of a suitable installation only. It is the responsibility of the end user to check the installation instructions of their electrical appliances to ensure that the location in relation to the gas fire is suitable. Escea in no way guarantees or takes responsibility that the above installation suggestion will be suitable for all electrical or home entertainment appliances.

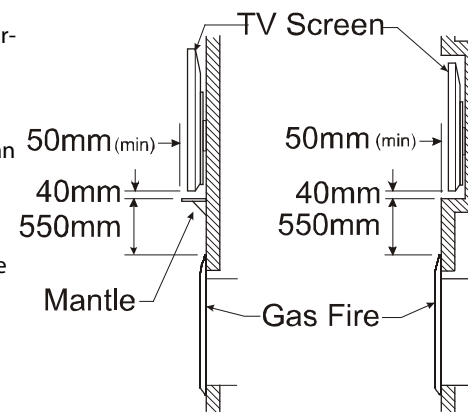

### Mantle Clearance

Please refer to the diagram. Mantles or protruding ledges above the heater must not be installed lower than the dimension shown.

Note: dimension from the top edge of the glass frame.

