

GB80 & GB80T (Cabinet Only)

# GRANDANGOLO BOX.

*Michel César*  
bathroom collection



Grandangolo Box GB80 with YOVA01 DX Basin in Walnut.

## 800 Wall Hung, 1 Drawer plus 1 Concealed drawer

+ Dimensions — **W** 800mm **H** 400mm **D** 500mm

+ Paint — The paint used on our products is polyurethane or UV based. It is five times harder and more durable than lacquer finishes. Hundreds of colour matches available.

+ Timber finishes — Our timber finishes are available Dark Oak, Natural Oak, White Oak, Walnut, Noce, Chestnut and Tussock. Being 100% natural products, each will have variations in grain and colour. All come stained and sealed with a protective UV finish.

## Finishes



Dark Oak

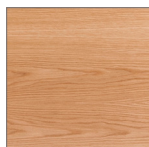

Natural Oak



White Oak

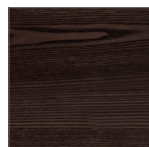

Noce



Walnut



Chestnut

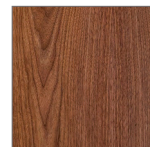

Tussock

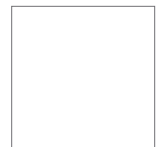

White Paint Finish

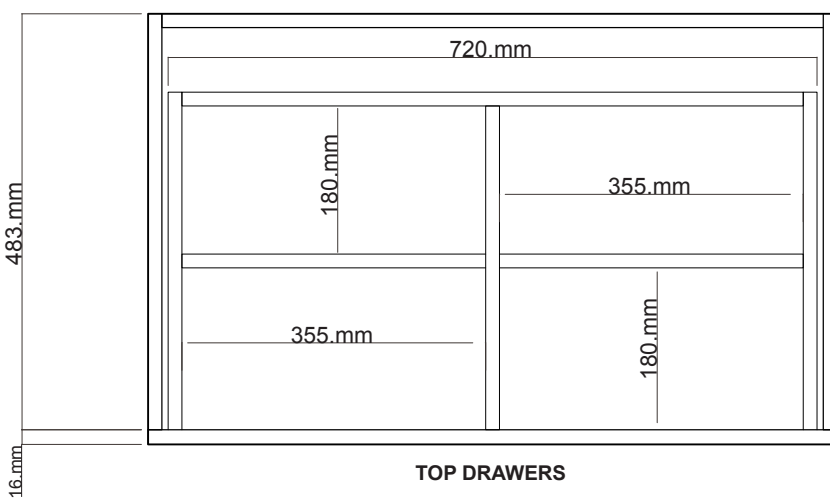
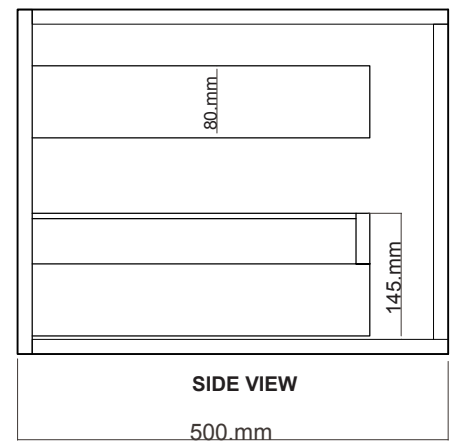
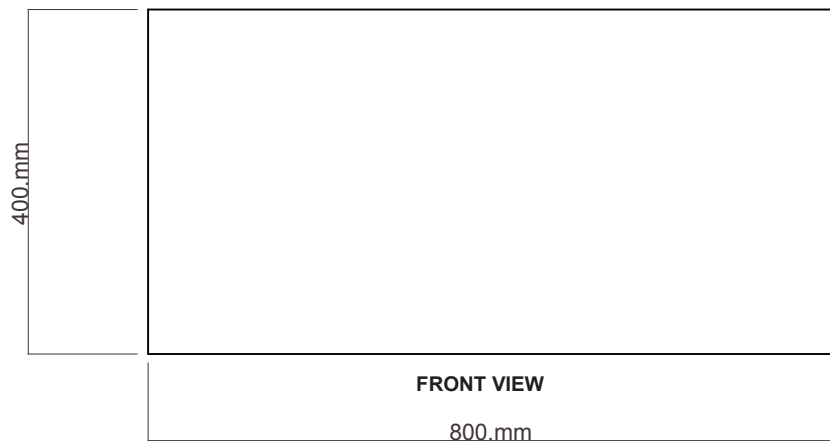
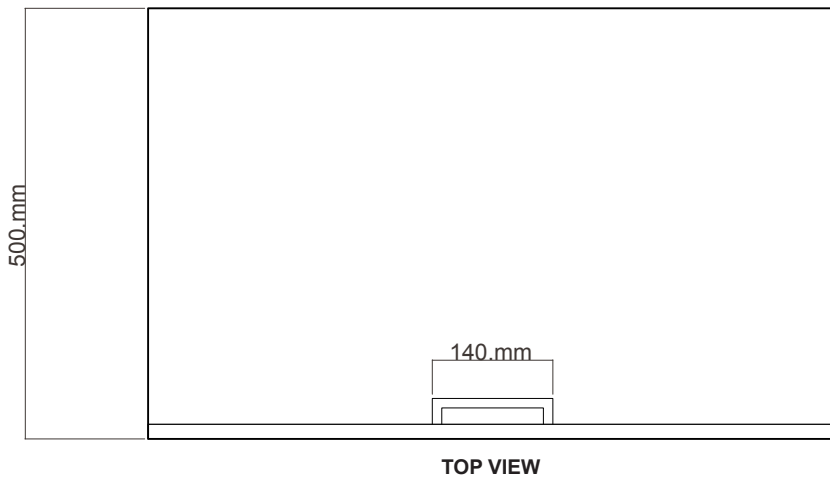

## GRANDANGOLO BOX

Code: GB80

Description: Grandangolo Box  
800 Drawer Plus 1  
Ceacealled Drawer,  
White Cabine.

NB: Must use a bottle trap to avoid drawers. We recommend 40551-32 Bottle Trap. Please use contoured waste with all china basins. We recommend A27 or FT41045 waster. Refer to Michel Cesar catalogue for further details.

NB: Drawings indicate the technical measurements only and is not a reflection of how the unit will look.